

- 1) FLASHING FIXED WITH TRADITIONAL PLUMBERS' DETAIL
- 2) WATERPROOF JOINT FILLER
- 3) 20MM TWO COAT MASTIC ASPHALT
- 4) MIN. 150MM HIGH 13MM TWO COAT SKIRTING WITH ANGLE FILLET AND SOLAR REFLECTIVE PAINT
- 5) COMPRESSIBLE INFILL
- 6) CONCRETE UPSTAND
- 7) SOLAR REFLECTIVE TREATMENT
- 8) 20MM TWO COAT MASTIC ASPHALT
- 9) SEPARATING MEMBRANE
- 10) BOARD TYPE THERMAL INSULANT
- 11) VAPOUR CONTROL LAYER
- 12) CEMENTITIOUS SCREED LAID TO FALLS
- 13) CONCRETE ROOF DECK

- 1) METAL COLLAR CLIPPED TO PIPE
- 2) NON-FERROUS METAL SLEEVE TO PIPE
- 3) MIN. 150MM HIGH 13MM TWO COAT SKIRTING WITH ANGLE FILLET AND SOLAR REFLECTIVE PAINT
- 4) SOLAR REFLECTIVE TREATMENT
- 5) 20MM TWO COAT MASTIC ASPHALT
- 6) BOARD TYPE THERMAL INSULANT

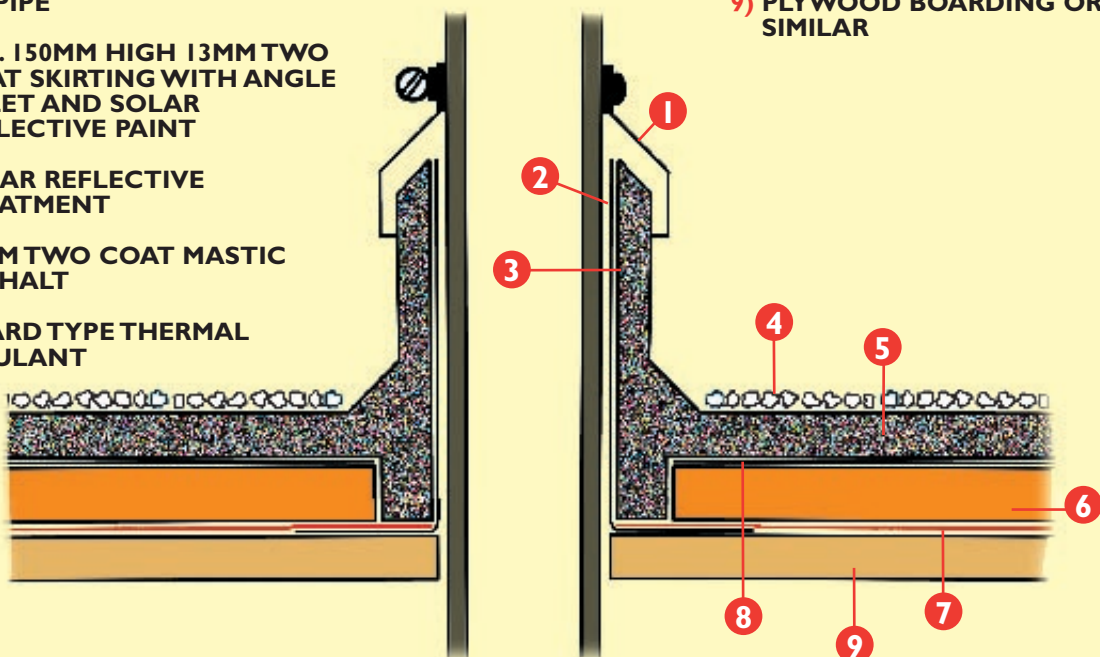

- 7) VAPOUR CONTROL LAYER
- 8) SEPARATING MEMBRANE
- 9) PLYWOOD BOARDING OR SIMILAR